

Volumetric dividers

GD GDS

- ✓ Open hopper volumetric divider
- ✓ Stainless steel exterior
- ✓ Regularity
- ✓ Strong pace
- ✓ Built-in flour dispenser (optional on the GDS)
- ✓ Pre-rounding of dough pieces (only on the GDS)



960 to 2000 pieces an hour

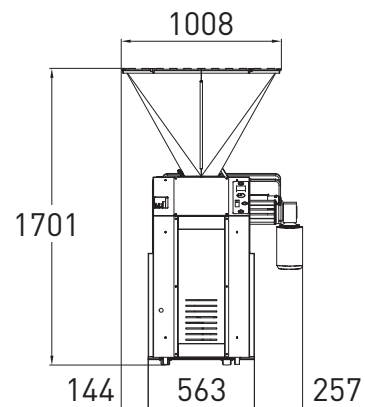
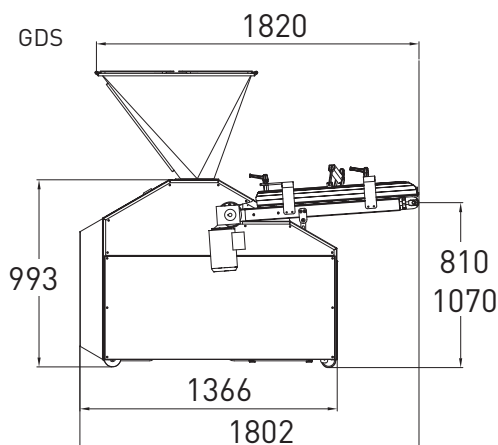
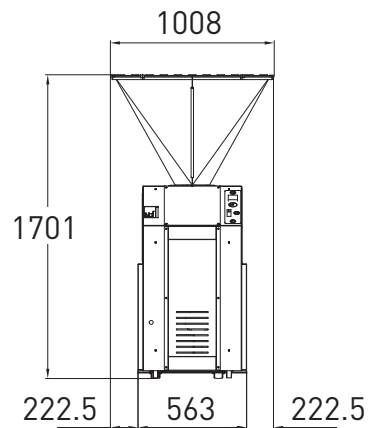
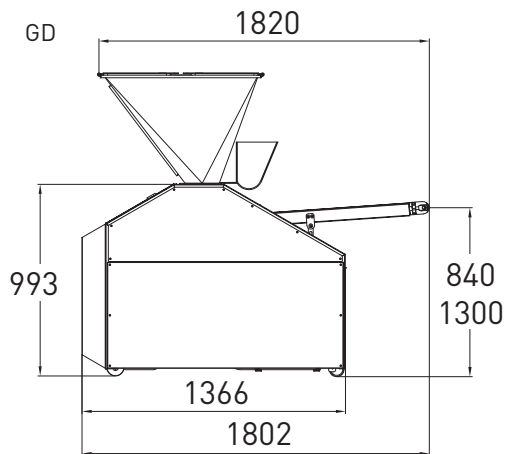

Traditionally Innovative

www.jac-machines.com

info@jac-machines.com

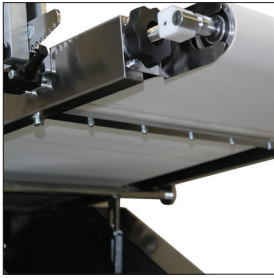

Outfeed belt scraper
The belt is kept clean throughout use.

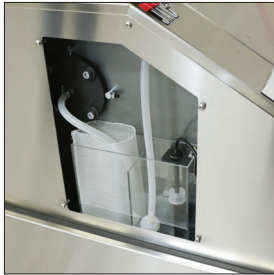

Oil recycling system
Reduces oil consumption.
Fitted with a filter and a low level alert.

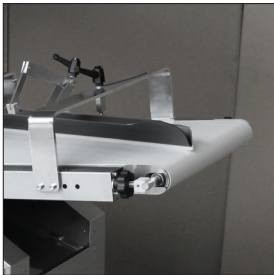

GDS
Adjustable pre-rounding tile
For pre-rounding dough pieces with different weights.

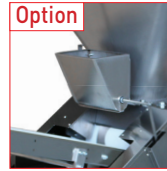

GDS
Built-in flour dispenser
Prevents the dough pieces from sticking to the belt.

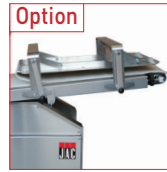

GDS
Dough piece rolling belt

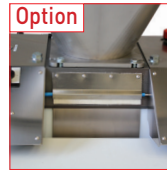

GDS
Dough piece lubrication

FEATURES	GD	GDS
Adjustable speed in pieces per hour	960 - 2000	960 - 2000
Teflon-coated hopper, capacity in kg	120	120
Programmable counter, countdown counter	•	•
Stainless steel drum	•	•
Triple-seal Rilsan piston	•	•
Stainless steel exterior	•	•
Outfeed belt width in mm	270	500
3-litre flour dispenser	•	
Outfeed belt scraper	•	•
Adjustable pre-rounding tile		•
Oil recycling system	•	•
Motor power in kW	2.2	2.2
Type of motor	400V three-phase	400V three-phase
Net weight in kg	525	575

CHOICES	GD	GDS
Outfeed belt length in mm	1060 or 1240	1060

OPTIONS	GD	GDS
3-litre flour dispenser		•
Dough piece lubrication		•
200 kg capacity Teflon-coated stainless steel hopper	•	•
Remote control	•	•
Dough piece rolling belt		•
Type of motor: 230V single phase	•	•
Type of motor: 230V three phase	•	•

	80 MM PISTON	100 MM PISTON	110 MM PISTON	120 MM PISTON	130 MM PISTON
Max/min weight of dough pieces in grams	30 / 370	50 / 700	70 / 850	90 / 1.000	130 / 1.300